

order number	lens name	f-stop
0009-194-000-40	Macro-CCD-Lens -4x	5.2

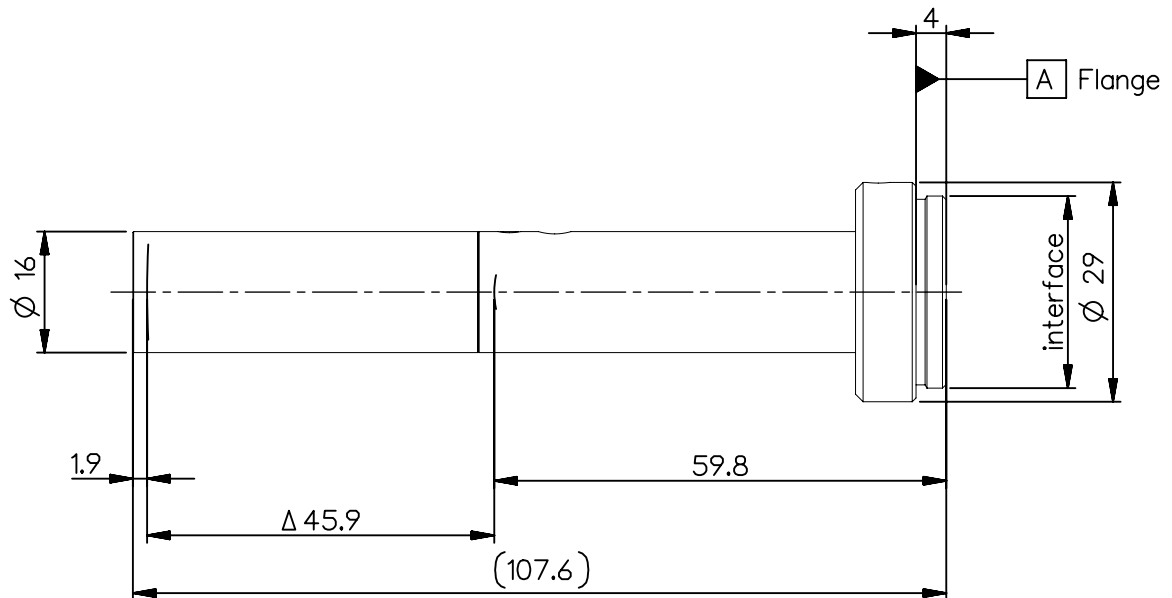

<b>Specification</b>		<b>ON</b>	
image circle max. (mm)	11	working distance (mm)	75
focal length $f'$ (mm) *	19.8	interface	C-mount
magnification $\beta'$ [range]	-4	filter thread	-
spectral range $\lambda$ (nm)	400 - 750	weight (g)	40
schematic diagram <span style="float: right;">*) in air</span> 		design includes CCD cover glass: no	
SF (mm)		32.5	f-stop
S'F' (mm) *		-4.4	$\varnothing$ EnP
HH' (mm) *		-30.7	$\varnothing$ Exp
SH (mm)		52.3	
S'H' (mm) *		-24.3	
SEnP (mm)			
S'Exp (mm) *			

NX PROTECTIVE NOTE "DIN ISO 16016" TO BE OBSERVED	EU-D		AL-T1A		US-D		US-ML		not export controlled	
	REV		DATE		APPROVED		PDM Status		-	
	a		17.09.14		Schiffner		Freigabe			
	ECC		DATE		APPROVED		SCALE		1:1	
Neuausg		17.09.14		Schiffner		MATERIAL				
						BASIC TOLERANCING PRINCIPLE		TITLE		
						FIRST		Macro-CCD-Lens 4x		
						DATE				
						ISSUE		17.09.14		
						NAME		Schiffner		
						CHKD		17.09.14		
						Stauder				
								DRAWING NO.		
								0009-194-100-40-0001c		
								SHEET 1		
								OF 1		
								REPLACES		

ALL DIMENSIONS ARE IN MM AND INCLUDE SURFACE TREATMENT

